

GR15082

Specifiche Tecniche

CENTRALINO DA ESTERNO 6-8 MODULI IP40

- STRUTTURA SPESSA IN MATERIALE TECNOPOLIMERO ABS A GARANZIA DI MASSIME PRESTAZIONI
- ROBUSTA ANTA IN POLICARBONATO
- TEMPERATURA DI LAVORO -15 + 60°C
- RESISTENTE AL CALORE FINO A 650°C GLOW WIRE TEST (CONFORMITÀ ALLA NORMATIVA: EN60335-1: 94 + IEC 695-2-1)
- CERTIFICATO IMQ
- RESISTENZA AGLI URTI IK08
- 400V
- 13W

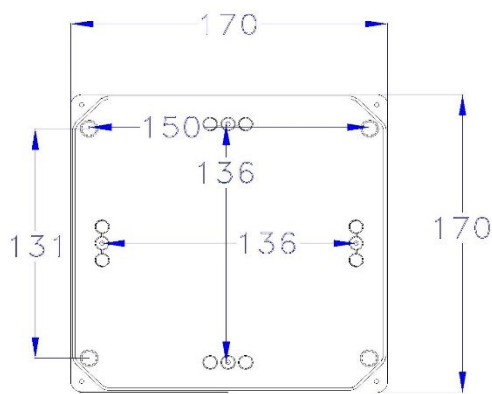
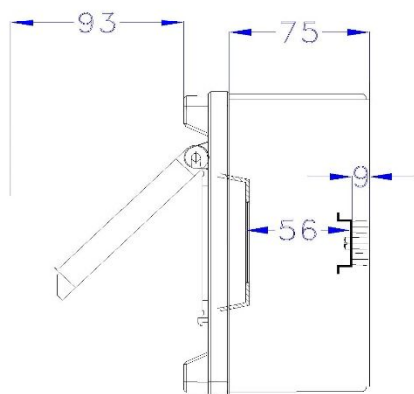
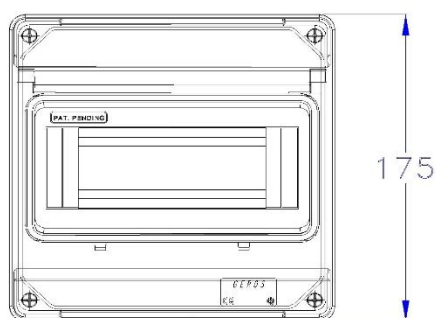
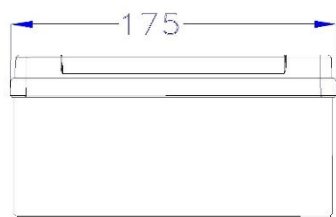

GR15082

Technical Specifications

IP40 6-8 MODULE SURFACE ENCLOSURE

- THICK STRUCTURE IN ABS TECHNOPOLYMER MATERIAL, GUARANTEEING MAXIMUM PERFORMANCE
- STURDY POLYCARBONATE DOOR
- WORKING TEMPERATURE $-15 + 60^{\circ}\text{C}$
- RESISTANT TO HEAT UP TO 650°C GLOW WIRE TEST (IN COMPLIANCE WITH STANDARDS: EN60335-1:94 + IEC 695-2-1)
- IMQ CERTIFIED
- SHOCK RESISTENCE IK08
- 400V
- 13W

